



Just In Times

Institute Of Industrial Engineers

South Jersey Delaware Valley Professional Chapter No. 132

<http://iienet2.org/Chapter/chap132/>



Theme: *Sustainability & Project Management*

Date: January 18, 2012
Wednesday

Schedule:

- 5:30 PM Social Networking
- 6:00 PM Dinner (\$20)
- 7:00 PM Presentation

Location:

Adelphia Restaurant
1750 Clements Bridge Road
Deptford, NJ 08096
(856) 845-8200

RSVP: Kevin Drevik
Kevin.drevik@lge.com

By: Friday, Jan 13, 2012

- *Everyone attending, including Board of Directors, needs to RSVP*
- *Thank You*

Newsletter Content	
Program Planning	1
Message from the President	2
Membership & Treasury Reports	
Officers Directory	3
Chapter Activity Report (CAR)	
NJIY Career Quest	4
Career Development Column	5
Employment Opportunity	6
Travel Notes from the Editor	7
2011 Election Results	8
Classified Ads	9 - 10

January Technical Dinner Meeting

Joint Meeting with the American Society of Quality *Solar Panel System*

Solar energy is becoming more economically attractive as technologies improve and the cost of electricity generated by fossil fuels rises.

By 2020, hundreds of billions of dollars of investment capital will probably boost global solar-generating capacity 20 to 40 times higher than its current level, according to a study by McKinsey Quarterly.

As the new sector takes shape, producers of solar component must drive their costs down, utilities must place big bets despite enormous technological uncertainty, and regulators must phase out subsidies with care.

However, make no mistake; this sector is still in its infancy. Even if all of the forecast growth occur, solar energy will represent only about 3 to 6 percent of installed electricity generation capacity, or 1.5 to 3 percent of output in 2020 (McKinsey). While solar power can certainly help to satisfy the desire for more electricity and lower carbon emissions, it is just one piece of the puzzle.

Claudio Conte will give our presentation for the January technical dinner meeting. Mr. Conte is the Director of Operations at Conte's Pasta, a privately held fresh and frozen Italian specialty food manufacturer in New Jersey. In his presentation, Mr. Conte will share with us an installation that he led over 2 years, now generating 1 million kilowatt hours a year for his company.



PRESIDENT'S MESSAGE

To all my fellow IIE South Jersey Delaware Valley Professional Chapter members, a Happy New Year to you all.

I am honored to be nominated again, and selected to be the Chapter President for 2012, as my second term I look forward to serving this Chapter, and all of you members in this outstanding region of the country.

IIESJDVPC has been a **Gold Award** winning Chapter, as well as maintaining a **Platinum Level** of Newsletter for quite some time, kudos to this Board of Directors working as a TEAM to consistently raise the bar of excellence.

We now live in a global economy, but there are a few things that are local, such as education, the environment, healthcare, and community service.

We, as a professional chapter, have evolved last year. We made a priority to network with other local professional chapters, so as to create a wider web of professional contacts. One example was we attended the International Association of Electrical Inspectors (IAEI) technical dinner meeting on overcurrent protection of solar panel systems, as well as continue to host joint meetings and plant tours with ASQ, and SME. We will continue to strive in providing meaningful technical dinner meetings that would engage topics in continual education, and professional development. We will also tap into relevant issues like sustainability, renewable energy as well as healthcare concerns from an industrial engineering perspective, such as quality improvements, delivery metrics, and cost efficiency. We also appreciate the complexity of these issues, which might not have easy answers, but could use constructive dialogues, and prudent analyses. By the way, our community service this month is Future City (details on page 3) on January 28.

We will continue to maintain a global awareness in economic and technological advances across all disciplines, and find the appropriate windows to share different points of view with you.

We look forward to having you to join us in one of our many technical dinner meetings this year.

Happy Holidays to you and yours,

Tom Fung

TREASURER'S REPORT

Mr. Richard T. Huysie reports a Treasury Balance of \$6,619.35 as of December 2, 2011 for the IIE South Jersey Delaware Valley Professional Chapter No. 132.

MEMBERSHIP REPORT

Membership Report: 169 as of December 2, 2011. **Don't forget to renew your membership. . . .**

'If you want to go quickly, go alone. If you want to go far, go together' . .



CALENDAR – JANUARY 2012

Key IIE dates:

- Jan 3 – IIE Board of Directors (BOD) Meeting
- Jan 18 – IIE Technical Dinner Meeting
- Jan 28 – Future City Competition

Sun	Mon	Tue	Wed	Thu	Fri	Sat
1 New Year	2	3 IIE BOD Meeting	4	5	6	7
8	9	10	11	12	13	14
15	16 MLK Day	17	18 IIE Tech Din Mtg	19	20	21
22	23	24	25	26	27	28 Future City
29	30	31				

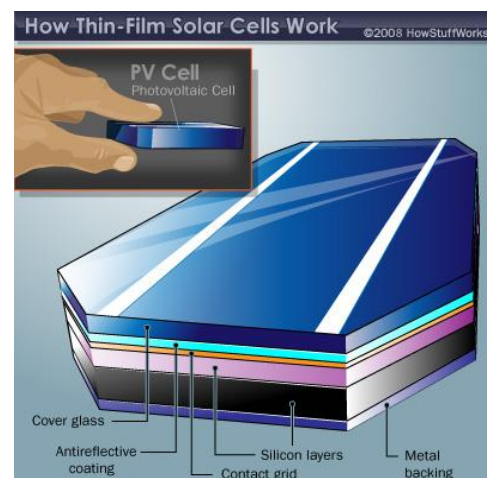

Officers & Directors
2011 IIE South Jersey Delaware Valley
Professional Chapter No. 132

President & Newsletter Editor - Tom Fung

tfung@alumni.upenn.edu,
fung@aesop.rutgers.edu,
fungt@PhilaU.edu
(C) 856-362-7238

Vice-President - Fred Rixon

fredrixon@precisionautomationinc.com
(W) 856-428-7400

Secretary - Bob Siebeneicher,

CMfgE, CSI, CFOM, F.IIE
Director of Career Development,
Constitution & By-laws, & Archivist
bobsiebeneicher2@aol.com
(C) 609-352-1957, (H) 856-235-9446

Treasurer - Rick Huysie

(H) 856-931-7352

IIE Northeast Region Vice President – Kevin Drevik

Kevin.drevik@lge.com
(W) 732-605-0385 x 245

Director of CAR & Engineer's Week - John McGowan, PE

john.p.mcgowan@lmco.com
(H) 856-722-4593

Director of Programs – Kevin Drevik

Kevin.drevik@lge.com
(W) 732-605-0385 x 245

Director of Membership & Education – Bob Siebeneicher,

CMfgE, CSI, CFOM, F.IIE
bobsiebeneicher2@aol.com
(C) 609-352-1957, (H) 856-235-9446

Director of Website & Web Master – Paul Siebeneicher

paulsehen@yahoo.com
(C) 856-630-5564

Director of Employment Assistance Network – Kevin Wiker

kevinwiker@gmail.com
(W) 215-781-2789

Director of Community Affairs, & PR – Michael Reyman

mreyman@mac.com

Director & Master at Arms – Frank DeFelice

fd744@aol.com

Director at Large – Marven Chin

Marven_Chin@medco.com
(W) 609-880-2172



CAR
Chapter Activity Report

Help Out Our Future Engineers

The volunteers from the Future City Philadelphia send their best wishes and a reminder of the volunteering opportunities they have for the current season. With just a few weeks left until registration closes – they have 53 schools signed up and a few schools that need mentors. Here is the latest list:

1. Our Lady of Calvary School - Philadelphia, PA
2. St. Ignatius School - Yardley, PA
3. St. Rose of Lima - Philadelphia, PA (Overbrook)
4. Samuel K. Faust Middle School - Bensalem, PA
5. Thomas Holme Elementary - Philadelphia, PA (Torresdale)
6. West Vincent Elementary School- Chester Springs, PA

These schools, and any more that register, need your help. Think of a project in your past – did it ever change for the better because someone on the team asked the right questions at just the right time?

Please visit the website at www.futurecityphilly.org click on On-Line Volunteer Form. There you can register to be a mentor, judge, or general volunteer. Sign up now and put Saturday, January 28, 2012 on your calendar!

Any questions please contact me via e-mail or phone. Please feel free to forward this e-mail to your friends, co-workers, and technical society members.

Thanks.

Jennifer Wetzel

Philadelphia Regional Volunteer Coordinator

Senior Project Manager

University of Pennsylvania

Facilities and Real Estate Services

Design and Construction

tel. 215-573-3935 fax 215-746-6606

jwetzel@upenn.edu

Our SJDV Professional Chapter will be a proud sponsor of one of the Special Awards in this year's Future City Competition held in Philadelphia. We look forward to seeing you there.

Career Quest[®] Workshop New Jersey Institute of Technology November 5, 2011

Director of Career Development, Bob Siebeneicher hosted his Career Quest[®] Workshop at the New Jersey Institute of Technology on a Saturday in November.

Siebeneicher created this unique career workshop with the goal to assist and support engineering students, especially those that are members of the IIE University Chapters and all levels of professionals to develop and practice their skills in continuous professional development. Director Siebeneicher and many other Directors of this Award Winning Professional Chapter have conducted numerous career workshops throughout our IIE Northeast Region. This interactive workshop facilitates resume building and honing interviewing techniques for many college students . . .

and with a successful 'hit rate' to help graduating seniors land their first professional job.



Tom Fung and Paul Siebeneicher joined the record setting workshop with 71 registered university students from NJIT, Rutgers, and Montclair State College. The all day workshop had students coming and going throughout the morning presentation and afternoon Mock Interviews, where they learned 'not to be eliminated', to network, fine tuned their career development tips and other helpful advice. Dr.

Anthanassios Bladikas, Program Director, and IIE Faculty Advisor on NJIT's BS & MS in Industrial Engineering and Engineering Management gave the keynote address to kick off the session. Pictured on the left column shows (from right) Bob, Dr. Bladikas, Paul, and Tom in the morning session of this two-session workshop.

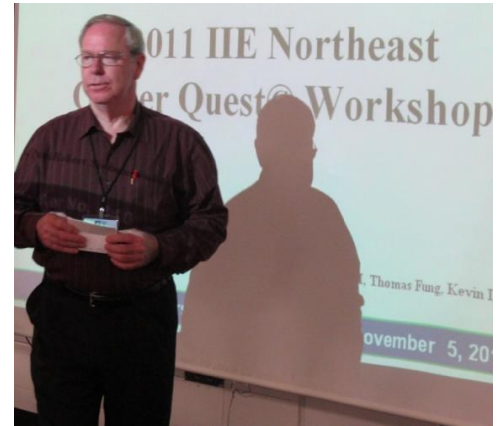

Bob (pictured at right) started the Workshop with a tutorial on resume building, the 'Dos and Don'ts' on resume writing.

We moved on to the 'Cover Letter' session, followed by professional networking. All of the 40 plus workshop participants were very engaging; out of the 71 registered, giving us over a '500 batting average' . . .



The NJIT IIE Student Chapter has done a fabulous job hosting this Career Quest Workshop

Kudos to this team, pictured above, from left, Nishant Paralkar, Agnish Tamrakar, Christian Nazon, Luz Katerine Palacios, Charles Abimana, and Jamie Bustamante.



Career Development

CONTINUING EDUCATION. DO YOU NEED CERTIFICATION.?

Yes! If you want to be more confident in the application of your knowledge and skills that you will employ in your career, the answer is a qualified yes. October's 2011 Career Development Column asked, ***“Do you need an M.B.A.?”*** You may want to earn and qualify for an E.I.T. and P.E.? You may want to continue your education by getting a degree in another field. This focus and treatise on certification is not to dissuade you from pursuing a different field of study or higher education. I simply want to share with you what other choices you have and how they have worked well within my career.

In my fifty years of working in the real world in 11 different industries for 12 different companies and corporations, I can tell you that 80% plus of us do not and will not need a P.E. License to be successful. While 100% of us do need and will need continuing education, most of us also do and will need certifications in specific fields, that is ***“If you want to be a professional, without the unique P.E. License, you will want to have the ‘credentials’ that say you are a professional.”*** Whatever and wherever your career takes you, you will always fare better having arrived with the ***‘credentials’*** and support of your certifications. There is a good chance that you will never arrive where you want to direct your career, if you do not have the ***‘credentials’*** your competition arrives with.

Today, recruiting and searching for a professional engineer in a specific industry or field often goes without the search being completed. Applicants often do not communicate well their capabilities and accomplishments when writing their resumes and cover letters in response to a specific ad. Wishing you could succeed in getting an invite to interview without ***‘credentials’*** is like wishing to find a pot of gold at the end of the rainbow with your dream! Couple this with the short time your cover letter and/or resume has in the hands of a screener, 20 to 30 seconds . . . the applicant with more ***‘credentials’*** wins.

My first certification was through the Society of Manufacturing Engineers as a ***Certified Manufacturing Engineer, CMfgE*** in 1980, some 31 years ago. I know for a fact that when the Executive Vice President of Infotron Systems Corporation asked me, after a 3 hour evening interview, how much annual salary I wanted for the position of Director of Manufacturing Engineering, he recognized my certification credentials. After starting, I soon was promoted to the Director of Facilities, Industrial & Manufacturing Engineering with a staff of 96 professionals reporting to me.

My second certification was through the Institute of Industrial Engineers as a ***Certified Systems Integrator, CSI*** in 1992, now 20 years ago. I was very involved in creating this certification program through the support of the local IIE South Jersey Chapter. I took on roles as the IIE Systems Integration Certification Preparatory Course Developer and Lead Seminar Instructor & Coordinator. I know for a fact that when the President and Owner of Camden Iron & Metal (CIM) asked me, after having left CIM 15 years prior, to come back as their Vice President of Operations & General Manager of their 100 million dollar Fragmentizing Division, he recognized my certification credentials. My next certification was through CIM's industry association, Institute of Scrap Recycles, Incorporated, as a ***Certified Facilities & Operations Manager, CFOM***, in 1994, now 19 years ago. There have been several other earned certifications along the way, but the above 3 have been very important to my career advancement and the many accomplishments achieved that my continuing education helped make possible.

I would be remiss in not recognizing my IIE South Jersey Delaware Valley Professional Chapter No. 132's support and all the Officers and Directors I have served with, and more important, the role that the Chapter has played in my career. It would be difficult to imagine another professional organization and platform that would have given me the same challenges to grow and the leadership opportunities to expand my horizons. For those that know me, besides being the oldest Director on the Chapter's Board, I am the busiest. I am the busiest, not because I want to be, but because I need to be to keep the kind of support and opportunities received alive and available to our IIE General Membership. While I try to get more of you involved and adding your influence, it has not been easy or successful. I cannot imagine not having a local IIE organization to go to for help and support. This is why I created the ***Career Quest® Workshops*** some 35 years ago. As my lovely wife Cass of 45 years points out, now at 68 years of age, it is time for others to take over the reins. Will you step up and ***“Make Things Happen”*** as I have tried to do?

Whatever time you devote to your professional Chapter will come back to you, because it provides the best networking opportunity imaginable. You will know who the ***“Go To”*** professionals are, what the ***“Hot Topics”*** are, where to focus your ***“Continuing Education”***, what and where to become ***“Certified”*** in, who are the best employers, and the list goes on . . . Sustainability begins with your continuing education. ***Will you be all that you can be?***

The IE is the “Change Agent” of the future! Make Your Career Happen! Educate, Proliferate . . . or Vanish! ©

Paul Robert Siebeneicher, II, CMfgE, CSI, CFOM, F.IIE

Director of Career Development – IIESJDVPC

Copyrighted 2011 – All Rights Reserve



Industrial Engineer - Distribution

Job Number: 39221609

Company Name: The SearchLogix Group

Location: Philadelphia, PA US

Career Focus: Management & Business

Posting Number: 201021P

Compensation: \$85K

Education Requirements: BS-Industrial Engineering

Contact Information

The SearchLogix Group

resumes@searchlogixgroup.com

Responsibilities

- Leading distribution process optimization/re-engineering efforts to address specific business requirements and to eliminate waste from the distribution processes
- Supporting supply chain projects and initiatives with a focus on reducing costs, improving quality, and improving customer satisfaction
- Implementing productivity improvements
- Working with cross functional teams from multiple sites to develop best practice solutions Utilizing a wide range of Industrial Engineering, Lean, and Six Sigma tools and techniques to make process improvements
- Implementing mistake-proofing controls to maintain or improve process quality
- Conducting root cause analyses to address specific process or quality problems
- Working with operations teams to identify potential projects, assess feasibility, and implement solutions
- Working with WMS and LMS systems to understand processes and performance metrics
- Conducting time studies and methods analyses to provide LMS maintenance support
- Documenting processes using process mapping and value stream mapping
- Assisting with the startup of a new DC operation
- Utilizing Lean and Six Sigma tools to lead and execute process improvement projects

- Designing facility layout alternatives

Required Skills

- A BS in Industrial Engineering or related engineering degree
- 5+ years of Industrial Engineering experience in a distribution environment
- 5+ plus years of experience managing multiple large projects
- Experience with WMS and LMS systems
- Strong leadership skills with proven ability to facilitate cross-functional teams
- Proficiency with all Microsoft Office applications required, including Project and Visio
- Proficiency with AutoCAD
- Experience with Minitab and MS Access a plus
- Ability to work both independently and as part of a team
- Strong analytical skills coupled with a creative and open mind towards alternative methods
- Technical competencies in Lean, Six Sigma, Kaizen, and process management
- Excellent written and verbal communication, presentation and facilitation skills
- Six Sigma certification a plus
- Ability to travel 20%-30%

<http://www.phillyjobs.com/job.asp?id=39221609&aff=AC44BA2E-E3EB-4DBC-8BDB-9FCE01C58B09>

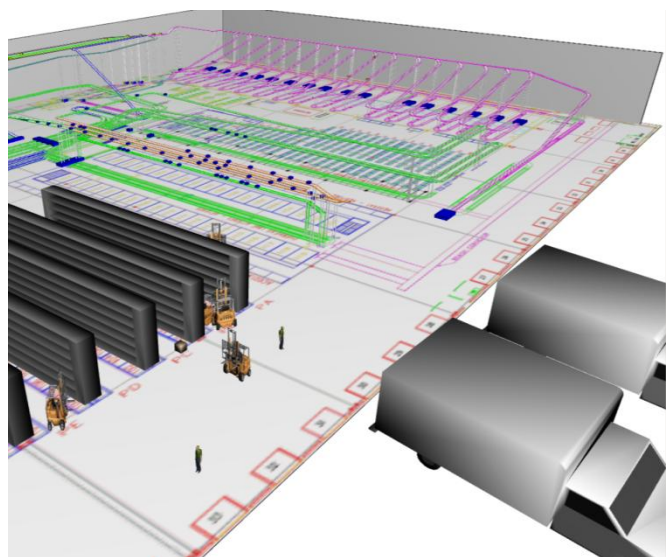



Travel Journal from the Newsletter Editor

I have been working with a client for over a year, and recently their product was featured in the New York Times. It is a Jersey tomato hand-crafted ketchup,

and was discovered by a restaurant chain owner in Asia, interested to try the product. The internet makes it all possible to do business globally while we take time to ‘slow cook food locally’. This product is now distributed in over 20 Whole Foods in the Northeast, as well as featured by a dozen upscale restaurants, from Brooklyn to Princeton. The Summit Hotel’s Hat Tavern (<http://www.hattavern.com/>) has been serving First Field ketchup since last summer.

I happened to be traveling to Asia in November, so I agreed to stop in to visit with this Asian restaurant owner . . . a great time indeed.

Beside my impromptu sales call, I also took a side trip to visit Guangdong. Imagine a province, with the land mass of the state of Minnesota, yet pouppaulted by more than the entire populations of Great Britian (62 million) combined

FOOD STUFF
Jersey Tomatoes? Jersey Ketchup!

By FLORENCE FABRICANT
 Published: August 30, 2011



Dan Neville/The New York Times

Enlarge This Image

This Labor Day, you can let loose those locavore instincts and slather your burgers with new seasonal ketchup made from New Jersey tomatoes. First Field, a company in Princeton, makes the ketchup from sustainably grown tomatoes seasoned with onions, cider vinegar, organic sugar, soybean oil, salt and spices. It is not quite as silky as the supermarket icon, and its flavor is a bit more robust. And after September, it will be gone until next year.



with Canada (30), plus a few more. Official count is 104, but it’s more like 120 when all the factories are running in full capacity with migrant workers coming in from all over China. Guangzhou is Guangdong’s capital, and recently they opened their first Opear House (pictured below), and it’s designed by Zaha Hadid (pictured at right), who in 2004 became the first woman to receive the Pritzker Architecture Prize, is known for the powerful, curving forms of her elongated structures. The entire structure



reminded me of the Guggenheim Museum in New York.

So making ketchup with South Jersey tomatoes got me to attend an opera in South China . . .

BRAVO . . .



Safe travels, my friends,

Tom

I flew 67,000 miles last year, and missed Continental's Platinum Elite Level of 75,000 miles. There is always this year.



INSTITUTE OF INDUSTRIAL ENGINEERS, INCORPORATED
SOUTH JERSEY DELAWARE VALLEY PROFESSIONAL CHAPTER NO. 132
OFFICIAL ELECTION RESULTS FOR THE 2012 CHAPTER YEAR

IIE OFFICER & DIRECTOR POSITIONS

President
Vice President
Secretary
Treasurer
Director of Career Development
Director of CAR & Engineer's Week
Director of Chapter Records & Archivist
Director of Community Affairs & Public Relations
Director of Communications & Newsletter Editor
Director of Constitution & By-laws
Director of Employment Assistance Network
Director of Membership & Education
Director of Programs
Director of Website & Web Master
Director & Master at Arms
Director at Large

IIESJDVP CHAPTER ELECTED LEADERSHIP

Thomas (Tom) T. Fung
G. Frederick (Fred) Rixon, Jr.
Paul Robert (Bob) Siebeneicher, II, CMfgE, CSI, CFOM, F.IIE
Richard (Rick) T. Huysie
Paul Robert (Bob) Siebeneicher, II, CMfgE, CSI, CFOM, F.IIE
John P. McGowan, PE
Paul Robert (Bob) Siebeneicher, II, CMfgE, CSI, CFOM, F.IIE
Michael (Mike) Reyman
Thomas (Tom) T. Fung
Paul Robert (Bob) Siebeneicher, II, CMfgE, CSI, CFOM, F.IIE
Kevin Wiker
Paul Robert (Bob) Siebeneicher, II, CMfgE, CSI, CFOM, F.IIE
Kevin Drevik
Paul Robert (Paul) Siebeneicher, III
Frank DeFelice
Marven Chin

The 2011 IIE South Jersey Delaware Valley Professional Chapter No. 132 Board of Directors is pleased to announce the election by the IIE South Jersey Delaware Valley Professional Chapter Membership of the 2012 IIE South Jersey Delaware Valley Professional Chapter Board of Directors on October 31, 2011. These election results authorize the 2011 IIE South Jersey Delaware Valley Professional Chapter No. 132 Board of Directors to accept and seat the 2012 IIE South Jersey Delaware Valley Professional Chapter No. 132 Board of Directors, effective Sunday, January 1, 2012. Installation of the 2012 Officers & Directors will be Tuesday evening, December 6, 2011, at our December 6, 2011 Board of Directors Meeting.

On the behalf of the IIE South Jersey Delaware Valley Senior Chapter Membership, I congratulate each and every South Jersey Delaware Valley Professional Chapter Member elected into their respective positions. We are fortunate to have most IIESJDVPC Officers & Directors returning and recognize your commitment and dedication to the IE profession and the IIE professional society.

The IIE Membership has elected these Officers and Directors to govern the South Jersey Delaware Valley Professional Chapter No. 132 of the Institute of Industrial Engineers for the 2011 Program Year. The administration of the South Jersey Delaware Valley Professional Chapter has been placed in their hands; however, the success of your Chapter depends upon the cooperation they receive from you in carrying out their directives and accomplishing the Chapter's goals. The measure of accomplishments depends upon individual application to the tasks assigned and voluntarily accepted. They will look to you to furnish them with mutual acceptance, experience, guidance, respect, and support to accomplish the desired objectives and achieve the best results from our individual and collective efforts. The strongest support you can provide is by participating in Chapter activities and attending the Chapter's programs.

I ask you to support them with the same spirit that they have demonstrated in accepting these leadership responsibilities. Demonstrate your IE professional spirit by actively participating in the activities and programs planned. Join your IIE leadership and become one of "*those who make things happen.*" Please be reminded that while the election process is concluded for the 2012 Program Year, you still have an open invitation and opportunity to serve your IIE Professional Chapter in many different roles and many different ways while helping family and community. We need you as mentors for the 2012 Future City Competition. We need you to take on the leadership role for Mathcounts 2012, which will be our ninth year of supporting the southern New Jersey's 7th and 8th Grade Mathletes in the National Mathcounts Competition sponsored by NSPE at Rowan University. All IIESJDVPC Members have a standing invitation to attend any or all of our Board Meetings. If a special project comes up with your child's school or your family's church, or even your local township that would benefit from industrial engineering principles and practices, please contact one of your IIESJDVPC Officers or Directors for assistance. This is your window to the IE profession. We look forward to seeing you often in 2012 and beyond.

Paul Robert Siebeneicher, II

PAUL ROBERT SIEBENEICHER, II, CMFGE, CSI, CFOM, F.IIE
Chairman of the South Jersey Delaware Valley Professional Chapter No. 132 2012 Nominations Committee
2011 Secretary, Director of Career Development, Constitution & Bylaws and Chapter Records & Archivist
1973 - 2012 IIE South Jersey Delaware Valley Professional Chapter No. 132 Board of Directors

IIE – SJDVPC Classified Ads

Integrated Conveyor Solutions

for Manufacturing, Distribution, Warehousing, and Processing.



Solutions that Work!

Time to Organize your Packing & Shipping Area?

Is your goal to Reduce Manual Handling and increase productivity?

Whether an Improvement or a New System our staff, with 60 plus years of experience, can help find the solution to meet your:

- Productivity Needs
- Space Requirements
- Quality Control Issues
- Efficiency Objectives



precisionautomationinc.com

Precision Automation® Co., Inc. • Cherry Hill, NJ • 856-428-7400

1-800-SCRAP IT



1-800-SCRAP IT

Camden Iron & Metal was incorporated in 1929, but was already the area's largest recycler before 1900. We became a European Metal Recycling company in January 2008. EMR is one of the world's largest recyclers with over 75 companies. Did you know that recycling 1 aluminum can will save enough electricity to run a laptop computer for 10 hours? Or, that recycling 1 pound of iron (ferrous) saves 5,450 BTUs of energy, enough to light a 60-watt bulb for over 26 hours? Recycling saves Resources, Energy, the Environment and Jobs! CIM pays the highest price for all metals. Our CIM Buyers are available to help you recycle any post consumed metals, ferrous and nonferrous, from your home, business or township. Please call our 800 Number today, or one of our CIM Buyers directly:



Ferrous Metals

Mike DiOrio – 215-952-1515
Steve Cirillo – 215-952-1505

Non-Ferrous Metals

Stephen Deacon – 856-969-7050
Joe Cirillo – 856-969-7033



Tom Fung
Newsletter Editor
South Jersey Delaware Valley
Professional Chapter No. 132
IIE, Incorporated
c/o 450 East Broad Street
Bridgeton, NJ 08302

This is a real estate advertisement for Mike Reyman. On the left, the Prudential logo is shown above the name 'Mike Reyman' and the title 'REALTOR®'. Below this, the company name 'Fox & Roach, REALTORS®' is listed, along with the address 'Media Home Marketing Center, 601 E. Baltimore Pike, Media, PA 19063', phone numbers (Bus 610 566-3000, Direct 610 892-5724, Fax 610 566-8664, Cell 908 967-8170), and email 'Mike.Reyman@prufoxroach.com'. There are also logos for 'green' (NAR's Green Designation) and 'MLS'. A small text at the bottom states 'An Independently Owned and Operated Member of The Prudential Real Estate Affiliates, Inc.'. On the right side of the advertisement is a portrait of Mike Reyman, a man with a beard and mustache, wearing a suit and tie.

In support of our **SOUTH JERSEY DELAWARE VALLEY PROFESSIONAL CHAPTER OF THE INSTITUTE OF INDUSTRIAL ENGINEERS**, 5% of my commission on a purchase or sale of a home (where a member of IIE made the first contact with me) will be donated back to the chapter at closing.

Start by checking out my website for your next move!

<http://www.ForSaleinDelawareCounty.com>

Or, just scan this to find me:

